



# FAÇADE CLADDING

System Solutions for Walls

SYSTEM OVERVIEW



## Foreword

This brochure provides a summary of wall panel applications made with the RHEINZINK titanium zinc alloy. This overview will serve as a guide for design and planning in accordance with current building practices.

RHEINZINK is an architectural grade zinc with trace elements of titanium and copper. It is easily formed into panels for use on both traditional and modern architecture for a timeless aesthetic. A natural metal, it has a low embodied energy and is infinitely recyclable. A long life material, requiring little to no maintenance, makes it a great value over the life of the building.

Though very versatile, RHEINZINK may not be suitable for all buildings. The design drawings illustrated in this brochure pertain to standard applications only.

Information herein is only a baseline for system design and installation. Modification to meet project requirements is the responsibility of the designer and architect. RHEINZINK America staff are available to assist the designer and architect in this process. RHEINZINK America makes no representations and warranties other than those expressed herein.

RHEINZINK reserves the right to make changes or adjustments based on research and development. For questions pertaining to any system, please contact our Technical Department.

Woburn, January 2013







*TRUMPF Sachsen GmbH, Neukirch, Germany*



*Terrace-shaped building, Oswaldgasse, Vienna, Austria*



*New Lecture Hall, Victoria University, Werribee Campus, Werribee, Australia*

## **RHEINZINK-Flat-Lock Tiles**

The flat overlapping seams of the Flat Lock Tile System provide a subtle gridded look to simple, complex rectilinear or curvilinear facades. By using various sized tiles and changing the layout of the seam lines, the planner has many design options.

- Individual tile sizes
- Perfect for curvilinear surfaces
- Little or no maintenance



*Fig. Cover Page: Operations Building, Montegrano, Italy*

*Fig. Left: Observation Tower, Haenam Gun, Jeon-Nam Province, Korea*



*Olympic Stadium, Jinan, China*



*Head Offices of Berlinwasser Holding AG, Berlin, Germany*



*Sir Colin Campbell Building, University of Nottingham, Great Britain*

## **RHEINZINK-Small Tiles**

Square and diamond-shaped tiles make up the RHEINZINK small tiles group. These tiles have hems in place to form simple, lock joints. The small format of these tiles permit aesthetically pleasing solutions and virtually all corners and curves can be accommodated. Curvilinear and complex surfaces are clad with ease due to the natural flexibility and formability of the material.

- **Templates available for ease of fabrication**
- **Perfect for complex curves**
- **Durable and long-lasting**

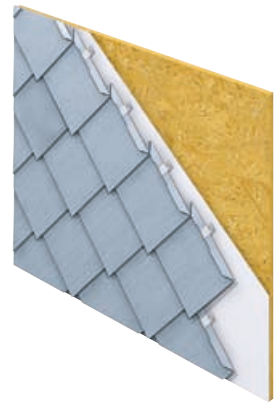



*Zinkhaus, Copenhagen, Denmark*



*Perth Convention & Exhibition Centre,  
Perth, Australia*



*Villa, Prague, Czech Republic*

## **RHEINZINK-Standing Seam Panels**

The RHEINZINK-Angled Standing Seam System, commonly used on facades, exhibits strong linear shadows produced by its angled seam configuration. The widespread availability of standing seam fabrication machines ensures consistent forming of panel edges as well as closing of the seams. Differing panel lengths and widths make it possible to achieve even the most complicated geometries. The angled standing seam system can be oriented horizontally, vertically and diagonally.

- Suitable for most building types
- Accommodates complicated geometries
- Can be installed horizontally, vertically or diagonally







*Private Residence, Cantù, Italy*



*Telenor, Fornebu, Norway*



*FERl, Maribor, Slovenia*

### **RHEINZINK-Horizontal Panel System**

One benefit of a reveal panel system is the choice of face heights of up to 13" and variable joint widths from 0-1". Panel end joints can be configured to create vertical joints or can be staggered with backer plates, allowing the horizontal joints to be emphasized. Combining horizontal and vertical panels create a striking design. The possibilities are endless. Installation of this system is done from top to bottom.

- Can be installed horizontally or vertically
- Face heights to 13"
- Reveals create striking shadows

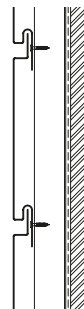

*Fig. Right: Private residence, Straden, Austria*









Apotex Centre, Faculty of Pharmacy, University of Manitoba, Winnipeg, MB, Canada



Private Residence, Empel, Netherlands



MG AVU Galerie der modernen Kunst Akademie bildender Kunst, Prague, Czech Republic

## RHEINZINK-Shiplap Panel

Due to its layered characteristics and shadow less joints, the shiplap panel is a unique cladding, reminiscent of wooden façades. When exposed to light and shade, sharp contours appear because of its profile geometry. Contrary to the horizontal and vertical reveal panels, this system does not have any reveals. Precision manufacturing (in accordance with detailed planning and pre-defined panel dimensions) guarantees efficient and optimum installation on site.

- Layered panel look
- Horizontal installation
- Scalloped design

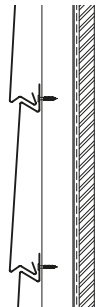



*University of Nottingham, Business School, Nottingham, Great Britain*



*Theater am Marientor (previously: Les Misérables), Duisburg, Germany*



*Tropical Islands, Briesen-Brand, Germany*

## RHEINZINK-Reveal Panels

Along with the horizontal reveal panels, the vertical reveal panels have a variable reveal width ranging from 0-1". With the flexibility of vertical and horizontal installation, the reveal panel offers the designer an exceptional amount of freedom in implementing their ideas. Solutions may be executed quickly when it comes to renovations or retrofitting installations. Installation of this system is done from top to bottom.

- Can be installed horizontally and vertically
- Face width to 13" for horizontal applications
- Face width to 16" for vertical applications







*Private Residence, Berlin, Germany*



*Multisport Complex, Walferdange, Luxembourg*



*Private Residence, Datteln, Germany*

## **RHEINZINK- Corrugated Sinusoidal Profiles**

The sinusoidal profile is most commonly known as the "wave" corrugated and is available for both exposed and concealed fasteners. From a design point of view, the corrugated panels are characterized by the slight exchange of light and shadow, which will vary depending on the corrugation height. This system may be installed horizontally, vertically or diagonally.

- Can be installed horizontally, vertically and diagonally
- Accentuated façade design
- Clad large areas with ease

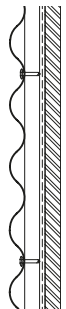



Verbier Gondola Station, Verbier, Switzerland



Rosenberg School, Neuhausen, Switzerland



Verbier Gondola Station, Verbier, Switzerland

## RHEINZINK- Corrugated Trapezoidal Profiles

Commonly known as the “box” corrugated, this system offers ease of installation and may be arranged horizontally, vertically or diagonally. When compared to the sinusoidal corrugated, trapezoidal profiles are characterized by having a more robust exchange of light and shadow.

- Exposed fastening system
- Clean design lines
- Crisp edge design

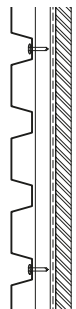

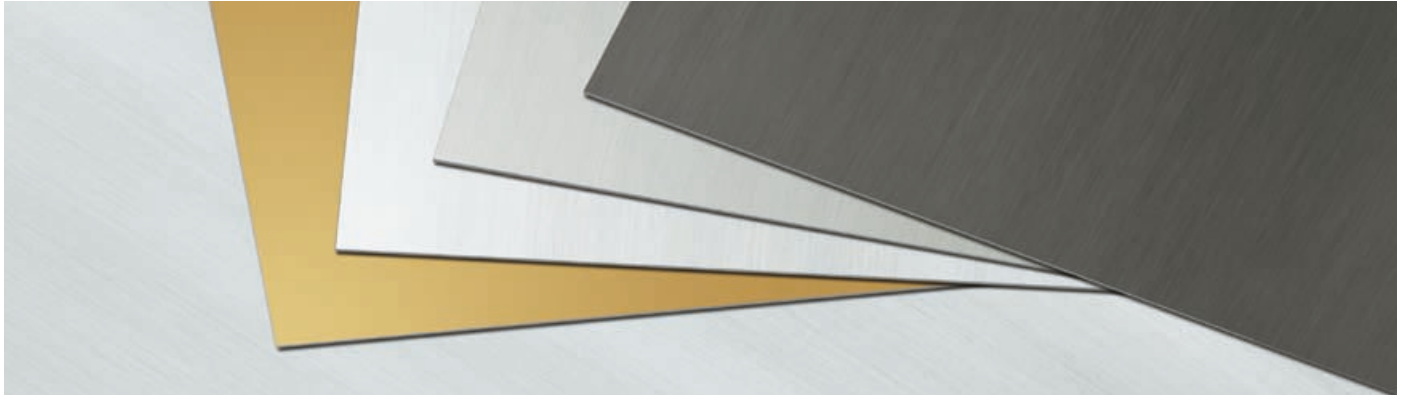

## Always better

Sustainable construction needs environmental building products. In addition to its longevity, a product's embodied energy is a key factor as is its recyclability and the abundance of its material resources.

RHEINZINK complies with the strictest environmental standards. It is infinitely recyclable and made of an abundant resource with low embodied energy. RHEINZINK is sustainable from two standpoints: production and performance. For over 45 years, we have made every effort to source products upstream as ecologically responsible as possible. Benchmarks have been set for both material extraction and processing. Modernization of production facilities have reduced emissions to a historic low and from our emissions, RHEINZINK purifies and recycles water to the village of Datteln, Germany – where the plant is located.

RHEINZINK products provide an opportunity for LEED certified projects as it has been declared an environmentally friendly building product by Cradle to Cradle and by ISO as a 14025 Type III product.

RHEINZINK meets ASTM B-69-11 Types 1 and 2 for Architectural Rolled Zinc. Type 1 is for RHEINZINK bright rolled and RHEINZINK blue-grey zinc. Type 2 is for RHEINZINK graphite-grey. Currently RHEINZINK is the only zinc manufacturer with a Type 2 designation.

In addition to its exemplary environmental properties is its aesthetic appearance and self-healing surface. From weathering, the protective patina diminishes any imperfections assuring a low-to-no maintenance lifespan of many decades. This applies to the RHEINZINK-PATINA LINE. This classic line, consisting of prePATINA bright rolled, prePATINA blue-grey and prePATINA graphite-grey surfaces will patinate as nature intended when exposed to wetting and drying cycles.

Over time, the prePATINA bright rolled takes on a natural patina when exposed to atmospheric influences while the preweathered materials prePATINA blue-grey and prePATINA graphite-grey will continue to age over time in response to microclimatic conditions.

The RHEINZINK-PROTECT LINE was developed in response to the effect of aggressive microclimates; its transparent coating slows down the aging process, prolonging its initial appearance. RHEINZINK-COLOR LINE is colored zinc that can be used to augment any project. Currently available in five shades: RHEINZINK-blue, RHEINZINK-tile-red, RHEINZINK-moss-green, RHEINZINK-pearl-gold and RHEINZINK-nut-brown.

All three product lines share the outstanding RHEINZINK processing characteristics. For further information regarding these products, contact a local RHEINZINK representative.



Please visit [www.rheinzink.us](http://www.rheinzink.us) for other product certifications.  
Contact us for additional information on the RHEINZINK family of products.



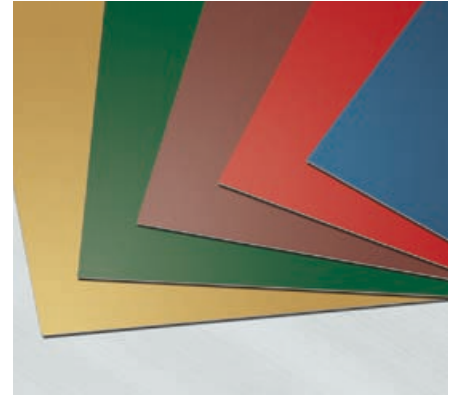
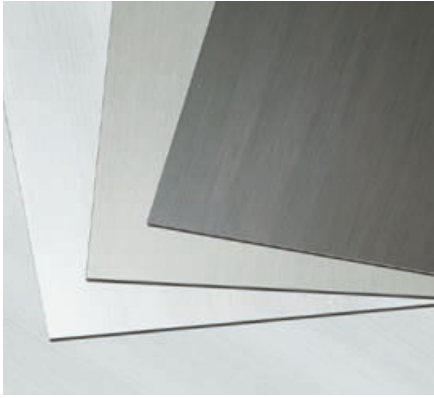

## Diversity instead of Monotony – The RHEINZINK-Product Lines



**PATINA LINE**  
Living Material

### Surface Qualities:

prePATINA bright rolled  
prePATINA blue-grey  
prePATINA graphite-grey



**PROTECT LINE**  
Pure and durable

### Surface Qualities:

PROTECT blue-grey  
PROTECT graphite-grey

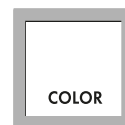

**COLOR LINE**  
Unlimited Design  
Possibilities

### Surface Qualities

#### (according to color catalog):

RHEINZINK-blue  
RHEINZINK-tile-red  
RHEINZINK-moss-green  
RHEINZINK-pearl-gold  
RHEINZINK-nut-brown

### Benefits:

- Natural material
- Develops a natural patina
- Easy to profile; malleable and bendable
- For roof, façade, roof drainage and architectural details
- A wide assortment of roof drainage goods and accessories
- Long life and low to no maintenance
- 100 % recyclable – infinitely

### Benefits:

- Natural material
- Clear coating providing durable surface protection
- Easy to profile; malleable and bendable
- For roof, façade, soffits and architectural details
- Durable and low to no maintenance
- 100 % recyclable – infinitely

### Benefits:

- Natural material
- RHEINZINK offers five standard colors
- Unlimited design possibilities
- Easy to profile; malleable and bendable
- For roof, façade, soffits and architectural details
- 100 % recyclable – infinitely



RHEINZINK America, Inc.  
96F Commerce Way  
Woburn, MA 01801  
USA

Tel.: +1 781 729 0812  
Fax: +1 781 729 0813

[info@rheinzipnk.com](mailto:info@rheinzipnk.com)  
[www.rheinzipnk.us](http://www.rheinzipnk.us)